

Assembly and Installation Instructions

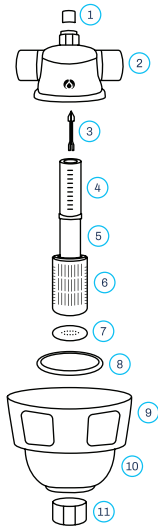

Dear installer,

This filter must be installed after the cutoff tap of house's main water supply between the water meter and the house.



TipaTech T-18 Whole house water system Parts included:

1. Air Vent
2. System Top
3. Rocket Rod
4. TipaTech Cartridge
5. Mesh Filter (upper side have an o-ring)
6. PF Filter
7. Net Cap
8. Silicon Flat Ring
9. Multi-Magnetic Sleeve
10. system base
11. Jet Valve

The box also contains:

12. L-Shaped Hanger
13. 2x 1" male NPT connector to 1" male BSP adaptors*

***Attention: the 1" BSP side comes with a white silicone seal and the 1" NPT side does not have a seal. Please make sure the BSP (male) side directly connects to the in/out 1" BSP (female) side of the T-18.**

If installation is not performed according to the instructions the fitting will be damaged.

Please, check the pressure.

If it is higher than 6 bar, we recommend installing a pressure modulator and setting it at a maximum of 4 bar.

Verify the size of the water piping thread on which the TipaTech will be installed. The TipaTech has an in/out 1" BSP (female). We also provide 2 adaptors that convert 1" BSP to 1" NPT (male/male). If the pipes are not the size of the TipaTech thread you will need to use adaptors.

For an easier installation you can separate the system base from its top and connect back in the end. Avoid using metallic reductions, use Teflon or Teflon thread.

Check the position for the correct connection to the water supply network.

Observe the direction of the arrows on the top of the TipaTech.

*** The T-18 must be installed in a protected area, protected from snow, freezing and direct sunlight.**

*** The T-18 must not be installed upside down or horizontally. It must only be installed in an upright position, with the AIR VENT on top and the drainage area on the bottom.**

*** Do not under any circumstances screw the AIR VENT to the T-18 with a wrench. This must only be performed manually.**

The TipaTech Cartridge should be installed with the grooved part facing the top, towards the water inlet. Insert the Rocket Rod with the arrowhead towards the top. After completing the installation leave a faucet running in the house and gently open the main tap of the drainage system. Flush the T-18 by opening the drain valve that comes with the filter for 10 seconds.

Attention: Please look for more maintenance instructions in the manual.